

# LICENSING ACT 2003

## Full Premises Licence

### The New Spires

Premises licence number	LN/205001261
-------------------------	--------------

#### Part One – Premises Details

Postal address of premises, or if none, ordnance survey map reference or description	
The New Spires Grayswood Avenue	
Post town	Post code
Coventry	CV5 8HJ
Telephone number	

Where the licence is time limited the dates
N/A

The times the licence authorises the carrying out of Licensable Activities		
Indoors	From	Capacity To
Exhibiting Film		
Indoor Sporting Event		
Live Music		
Recorded Music		
Performances of Dance		
Sunday	11:00	00:00
Monday	10:00	23:00
Tuesday	10:00	23:00
Wednesday	10:00	23:00
Thursday	10:00	23:00
Friday	10:00	23:30
Saturday	11:00	23:30

To permit sale of alcohol and such regulated entertainment as authorised hereunder until 01.00 on Friday, Saturday, Sunday and Monday at Bank Holiday weekends, Christmas Eve, Boxing Day and on up to 20 occasions per annum at my discretion



# LICENSING ACT 2003

## Full Premises Licence

upon 7 days prior notice to the Police (if required by them).

From the start of permitted hours on New Year's Eve to the end of permitted hours on New Year's Day.

To permit the premises to open for licensable activities to show the televised sporting events of national or international interest outside normal operating hours, such opening times for this purpose to be confirmed upon seven days prior notice in writing to the police before the premises intend to open, such notification to include the opening times and the sporting event which is to be shown.

Indoors		Capacity
<b>Late Night Refreshment</b>	<b>From</b>	<b>To</b>
<b>Sunday</b>	23:00	00:00
<b>Monday</b>	23:00	00:00
<b>Tuesday</b>	23:00	00:00
<b>Wednesday</b>	23:00	00:00
<b>Thursday</b>	23:00	00:00
<b>Friday</b>	23:00	00:00
<b>Saturday</b>	23:00	00:00

To permit sale of alcohol and such regulated entertainment as authorised hereunder until 01.00 on Friday, Saturday, Sunday and Monday at Bank Holiday weekends, Christmas Eve, Boxing Day and on up to 20 occasions per annum at my discretion upon 7 days prior notice to the Police (if required by them).

From the start of permitted hours on New Year's Eve to the end of permitted hours on New Year's Day.

To permit the premises to open for licensable activities to show the televised sporting events of national or international interest outside normal operating hours, such opening times for this purpose to be confirmed upon seven days prior notice in writing to the police before the premises intend to open, such notification to include the opening times and the sporting event which is to be shown.

On and Off Sales		Capacity
<b>Supply of Alcohol</b>		
<b>Sunday</b>	11:00	00:00
<b>Monday</b>	10:00	23:00
<b>Tuesday</b>	10:00	23:00
<b>Wednesday</b>	10:00	23:00
<b>Thursday</b>	10:00	23:00
<b>Friday</b>	10:00	00:00
<b>Saturday</b>	11:00	00:00



# LICENSING ACT 2003

## Full Premises Licence

To permit sale of alcohol and such regulated entertainment as authorised hereunder until 01.00 on Friday, Saturday, Sunday and Monday at Bank Holiday weekends, Christmas Eve, Boxing Day and on up to 20 occasions per annum at my discretion upon 7 days prior notice to the Police (if required by them).

From the start of permitted hours on New Year's Eve to the end of permitted hours on New Year's Day.

To permit the premises to open for licensable activities to show the televised sporting events of national or international interest outside normal operating hours, such opening times for this purpose to be confirmed upon seven days prior notice in writing to the police before the premises intend to open, such notification to include the opening times and the sporting event which is to be shown.

Open to the Public	Capacity	
	From	To
<b>Sunday</b>	11:00	00:30
<b>Monday</b>	10:00	00:30
<b>Tuesday</b>	10:00	00:30
<b>Wednesday</b>	10:00	00:30
<b>Thursday</b>	10:00	00:30
<b>Friday</b>	10:00	01:30
<b>Saturday</b>	11:00	01:30

On occasions when the hours for licensable activities are extended the premises will close 30 minutes afterwards.

**Where the licence authorises supplies of alcohol whether these are on and/or off supplies**

ON AND OFF SALES

### Part Two

**Name, (registered) address, telephone number(s) and email (where relevant) of holder of premises licence**

Marstons Plc  
Marston's House  
Brewery Road  
Wolverhampton  
WV1 4JT





# LICENSING ACT 2003

## Full Premises Licence

**Registered number of holder, for example company number, charity number (where applicable)**

00031461

**Name, (registered) address, and telephone number(s) of designated premises supervisor where the premises licence authorises the supply of alcohol**

Karl James Keable  
New Spires  
Grayswood Avenue  
Coventry  
CV5 8HJ

**Personal Licence Number and Issuing Authority of Personal Licence held by Designated Premises Supervisor where the premises authorises the supply of alcohol**

Licence number - CV210000323 - Coventry City Council

Dated this 28th April 2015

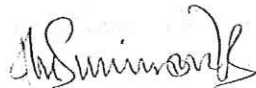

Head of Regulatory Services

  
Countersigned:

Regulatory Services  
Broadgate House  
Broadgate  
Coventry  
CV1 1NH

Page 4 of 4



**Annex 1**

**Mandatory Conditions**

**Section 19 Licensing Act 2003**

Where this licence authorises the supply of alcohol,

- 1. No supply of alcohol may be made under the licence:**
  - a. at a time when there is no designated premises supervisor (DPS) in respect of the licence, or**
  - b. at a time when the DPS does not hold a personal licence or that licence is suspended**
  
- 2. Every supply of alcohol under the licence must be made or authorised by a person who holds a personal licence**

**Section 20 Licensing Act 2003**

Where this licence authorises the exhibition of films,

- (1) the admission of children to the exhibition of any film will be restricted.**
- (2) Where the film classification body is specified in the licence, unless otherwise stated, admission of children must be restricted in accordance with any recommendation made by that body.**
- (3) Where :**
  - i. the film classification body is not specified in the licence, or**
  - ii. the licensing authority has notified the holder of the licence that this subsection applies to the film in question, admission of children must be restricted in accordance with any recommendation made by that licensing authority.**

**Section 21 Licensing Act 2003**

Where this licence includes a condition that at specified times one or more individuals must be on the premises to carry out a security activity, each such individual must be licensed by the Security Industry Authority.

## **The Licensing Act 2003 (Mandatory Licensing Conditions) Order 2014**

Where a licence authorises alcohol to be consumed on the premises the following conditions apply:

1. (1) The responsible person must ensure that staff on relevant premises do not carry out, arrange or participate in any irresponsible promotions in relation to the premises.

(2) In this paragraph, an irresponsible promotion means any one or more of the following activities, or substantially similar activities, carried on for the purpose of encouraging the sale or supply of alcohol for consumption on the premises—

(a) games or other activities which require or encourage, or are designed to require or encourage, individuals to—

(i) drink a quantity of alcohol within a time limit (other than to drink alcohol sold or supplied on the premises before the cessation of the period in which the responsible person is authorised to sell or supply alcohol), or

(ii) drink as much alcohol as possible (whether within a time limit or otherwise);

(b) provision of unlimited or unspecified quantities of alcohol free or for a fixed or discounted fee to the public or to a group defined by a particular characteristic in a manner which carries a significant risk of undermining a licensing objective;

(c) provision of free or discounted alcohol or any other thing as a prize to encourage or reward the purchase and consumption of alcohol over a period of 24 hours or less in a manner which carries a significant risk of undermining a licensing objective;

(d) selling or supplying alcohol in association with promotional posters or flyers on, or in the vicinity of, the premises which can reasonably be considered to condone, encourage or glamorise anti-social behaviour or to refer to the effects of drunkenness in any favourable manner;

(e) dispensing alcohol directly by one person into the mouth of another (other than where that other person is unable to drink without assistance by reason of disability).

2. The responsible person must ensure that free potable water is provided on request to customers where it is reasonably available.

3. (1) The premises licence holder or club premises certificate holder must ensure that an age verification policy is adopted in respect of the premises in relation to the sale or supply of alcohol.

(2) The designated premises supervisor in relation to the premises licence must ensure that the supply of alcohol at the premises is carried on in accordance with the age verification policy.

(3) The policy must require individuals who appear to the responsible person to be under 18 years of age (or such older age as may be specified in the policy) to produce on request, before being served alcohol, identification bearing their photograph, date of birth and either—



(a) a holographic mark, or

(b) an ultraviolet feature.

4. The responsible person must ensure that—

(a) where any of the following alcoholic drinks is sold or supplied for consumption on the premises (other than alcoholic drinks sold or supplied having been made up in advance ready for sale or supply in a securely closed container) it is available to customers in the following measures—

(i) beer or cider: ½ pint;

(ii) gin, rum, vodka or whisky: 25 ml or 35 ml; and

(iii) still wine in a glass: 125 ml;

(b) these measures are displayed in a menu, price list or other printed material which is available to customers on the premises; and

(c) where a customer does not in relation to a sale of alcohol specify the quantity of alcohol to be sold, the customer is made aware that these measures are available.”

**Licensing Act 2003 (Mandatory Licensing Conditions) Order 2014**

A relevant person shall ensure that no alcohol is sold or supplied for consumption on or off the premises for a price which is less than the permitted price.

For the purposes of the condition set out in paragraph 1—

(a) “duty” is to be construed in accordance with the Alcoholic Liquor Duties Act 1979;

(b) “permitted price” is the price found by applying the formula—

$$P = D + (D \times V)$$

## Annex 2

### Conditions consistent with the Operating Schedule

#### Licensees Statement of Operating Schedule as attached including:

##### Part 1

- A) General all four licensing objectives
- B) The Prevention of Crime and Disorder
- C) Public Safety
- D) Prevention of Public Nuisance
- E) Protection of Children from Harm

##### Part 2

Conditions reproducing the effect of all conditions currently attached to the existing licence (both standard and special conditions).

Licensing Act 1964- None

Theatres Act 1968- None

Cinemas Act 1985 - None

Local Government (Miscellaneous Provisions) Act, 1982 – None



Describe the steps you intend to take to promote the four licensing objectives:

**a) General - all four licensing objectives (b,c,d,e) (please read guidance note 15)**

I have undertaken my own risk assessment to take the following proposed steps.

The types of regulated entertainment proposed materially do no more than reinstate the normal pub entertainment that was previously unregulated as identified in B1 above.

No new steps have been identified in relation to the four licensing objectives save as below.

**b) The prevention of crime and disorder**

No further risks have been identified which need to be addressed, save as below

1. Any person exercising a security activity (as defined by paragraph 2(1)(a) of schedule 2 of the Private Security Industry Act 2001) shall be licensed by the Security Industry Authority.
2. Such a person will be employed at the premises at the discretion of the designated premises supervisor/holder of the Premises Licence.
3. Any person as defined in condition (1) will clearly display his name badge at all times whilst on duty.
4. No customers apparently carrying open bottles upon entry shall be admitted to the premises at any times the premises are open to the public.
5. Where CCTV is installed with recording facilities such recordings shall be retained for a period of 30 days and made available within a reasonable time upon request by the police.
6. Alcoholic and other drinks may not be removed from the premises in open containers save for consumption in any external area provided for that purpose.

**c) Public safety**

No further risks have been identified which need to be addressed, save as below

1. To comply with the reasonable requirements of the fire officer from time to time.
2. To comply with the reasonable requirements of the building control officer.

Converted to Word by  
John Gaunt & Partners  
Licensing Solicitors

13

**d) The prevention of public nuisance**

No further risks have been identified which need to be addressed, save as below

1. Where appropriate, prominent, clear and legible notices shall be displayed at all exits requesting the public respect the needs of local residents and to leave the premises and area quietly.
2. Noise or vibration shall not emanate from the premises so as to cause a nuisance to nearby properties.

**e) The protection of children from harm**

The restrictions set out in the Licensing Act 2003 will apply. No unusual or additional risks of harm to children have been identified.

No films or videos of any description will be shown so that they can be viewed by persons under the age of any applicable BBFC/Local Authority certification.

Children under the age of 16 shall not be permitted to enter the premises after 21:00.

LN 205001261 - THE RECTORY



## **Annex 3**

### **Conditions Attached after a Hearing by the Licensing Authority**

The standard timings for the supply of alcohol and provision of regulated entertainment on Mondays to Thursday shall be from 10.00 to 23.00 hours.

The standard timings for the supply of alcohol and late night refreshment on Fridays shall be from 10.00 to 23.30 hours.

The standard timings for the provision of regulated entertainment on Fridays shall be from 10.00 to 23.30 hours.

The standard timings for the supply of alcohol and late night refreshment on Saturdays shall be from 11.00 to 00.00 hours.

The standard timings for the provision of regulated entertainment on Saturdays shall be from 11.00 to 23.30 hours.

The standard timings for the supply of alcohol and provision of regulated entertainment on Sundays shall be from 11.00 and 23.00 hours.

**Annex 4**

**Plans**

**The Plan attached to this licence as attached.**



If Grid layout on this drawing has indicated against it  
 have the information was gathered and drawn.  
 Check Survey - Information has been drawn up  
 from original survey drawings and been checked on  
 site and modified accordingly.  
 Full Survey - Complete on site survey carried out

- KEY
- (1) General Fire Notice
  - (2) Staff Fire Notice
  - (3) "Fire Door Keep Locked" sign
  - (4) "Fire Exit Keep Clear" sign
  - (5) "Fire Door Keep Locked" sign
  - (6) Fire Blanket
  - (7) Dry Powder Fire Extinguisher
  - (8) Carbon Dioxide Fire Extinguisher
  - (9) Foam Fire Extinguisher
  - (10) Water Fire Extinguisher
  - (11) Emergency Light fitting
  - (12) Emergency Exit Sign
  - (13) Heat Detector
  - (14) Smoke Detector
  - (15) Break Glass Call Point
  - (16) Fire Alarm Sounder
  - (17) Fire Alarm Printer
  - (18) Arrangement with Friends
  - (19) Call with Phone
  - (20) Cash machine
  - (21) Pay Phone
  - (22) Juice Box
  - (23) Cigarette MC

All drawings are prepared in accordance with the British Standard BS 1192:2009  
 All dimensions shown shall be taken to the centre of the wall unless otherwise stated.  
 The drawings are prepared on the basis of the information provided and the surveyor does not accept liability for any errors or omissions.  
 The drawings are prepared on the basis of the information provided and the surveyor does not accept liability for any errors or omissions.

**fisherroad**  
 44, Fisher Road  
 Union Street  
 Cambridge  
 CB1 3JQ  
 Tel: 01223 554545  
 Fax: 01223 552117  
 Email: [enquiries@fisherroad.co.uk](mailto:enquiries@fisherroad.co.uk)  
 Website: [www.fisherroad.co.uk](http://www.fisherroad.co.uk)  
 VAT No: 254 084 000



Reactivity  
 Cayeswood Avenue, Coventry  
 CV3 5JF  
 FOR BUILDING DRAWINGS  
 GROUND & FIRST FLOORS

SCALE	DATE	BY	REVISED	REASON
1:100	11/10/06	...	...	...
1:100	11/10/06	...	...	...

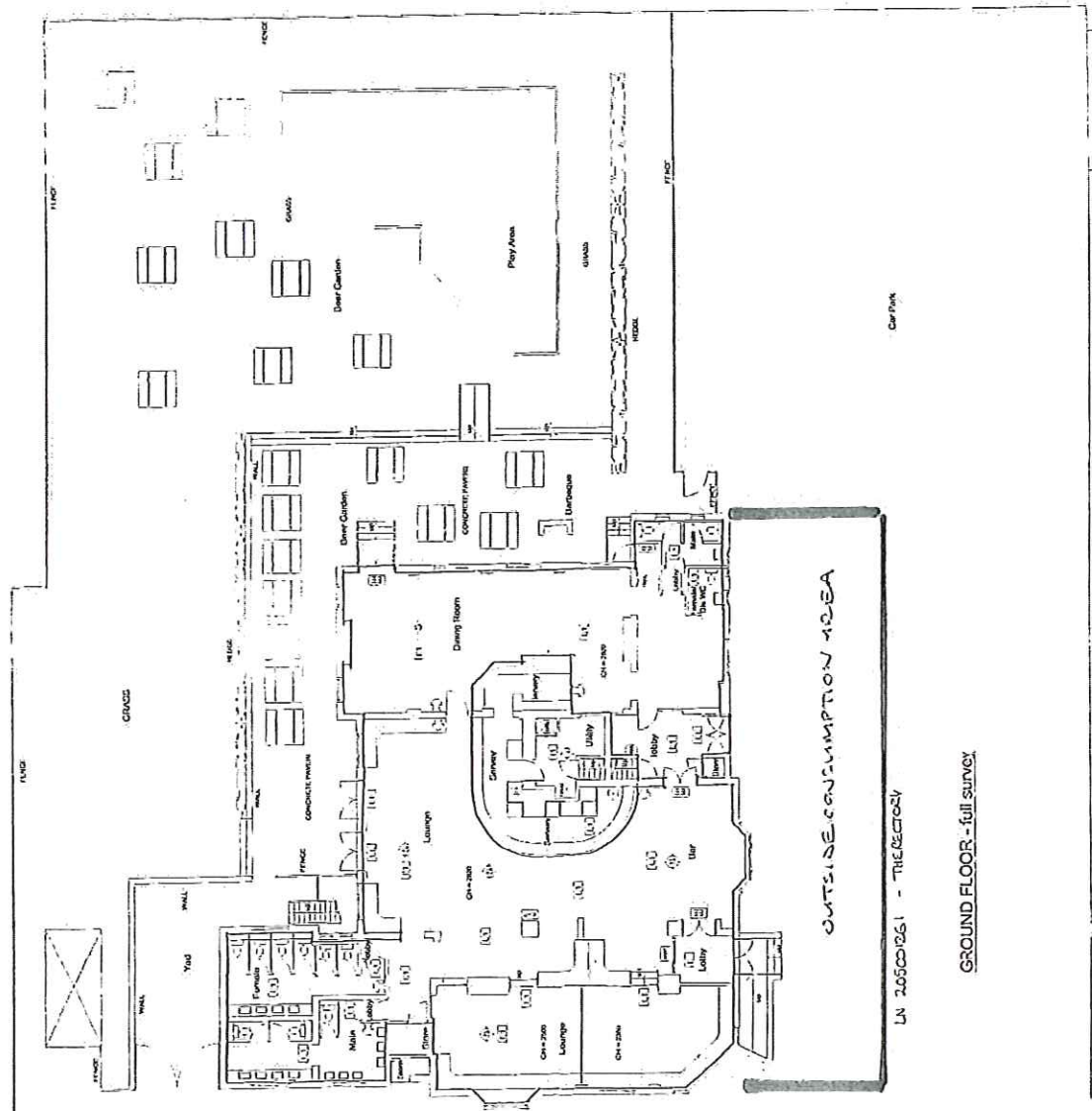

UN 20500261 - TRICELECTORY  
 GROUND FLOOR - FULL SURVEY

